

1 MAGNA1 50-120 F



: 97924192

MAGNA1 -

MAGNA1

MAGNA1

EuP.

: -10 .. 110 °C
 : 60 °C
 : 983.2 / 3

TF : 110
 : CE,VDE,EAC

EN-GJL-250
 ASTM A48-250B
 PES 30%GF

: 0 .. 40 °C

: 10

: DIN

: DN 50

: PN6/10

: 280

-P1: 20.2 .. 533

: 50 Hz

: 1 x 230

: 0.22 .. 2.37 A

(IEC 34-5): X4D

(IEC 85): F

(EEI): 0.21

: 17.8

: 19.6

: 57.4 ³

Danish VVS No.: 380763120

Finnish LVI No.: 4615280

Norwegian NRF no.: 9042847

97924192 MAGNA1 50-120 F 50

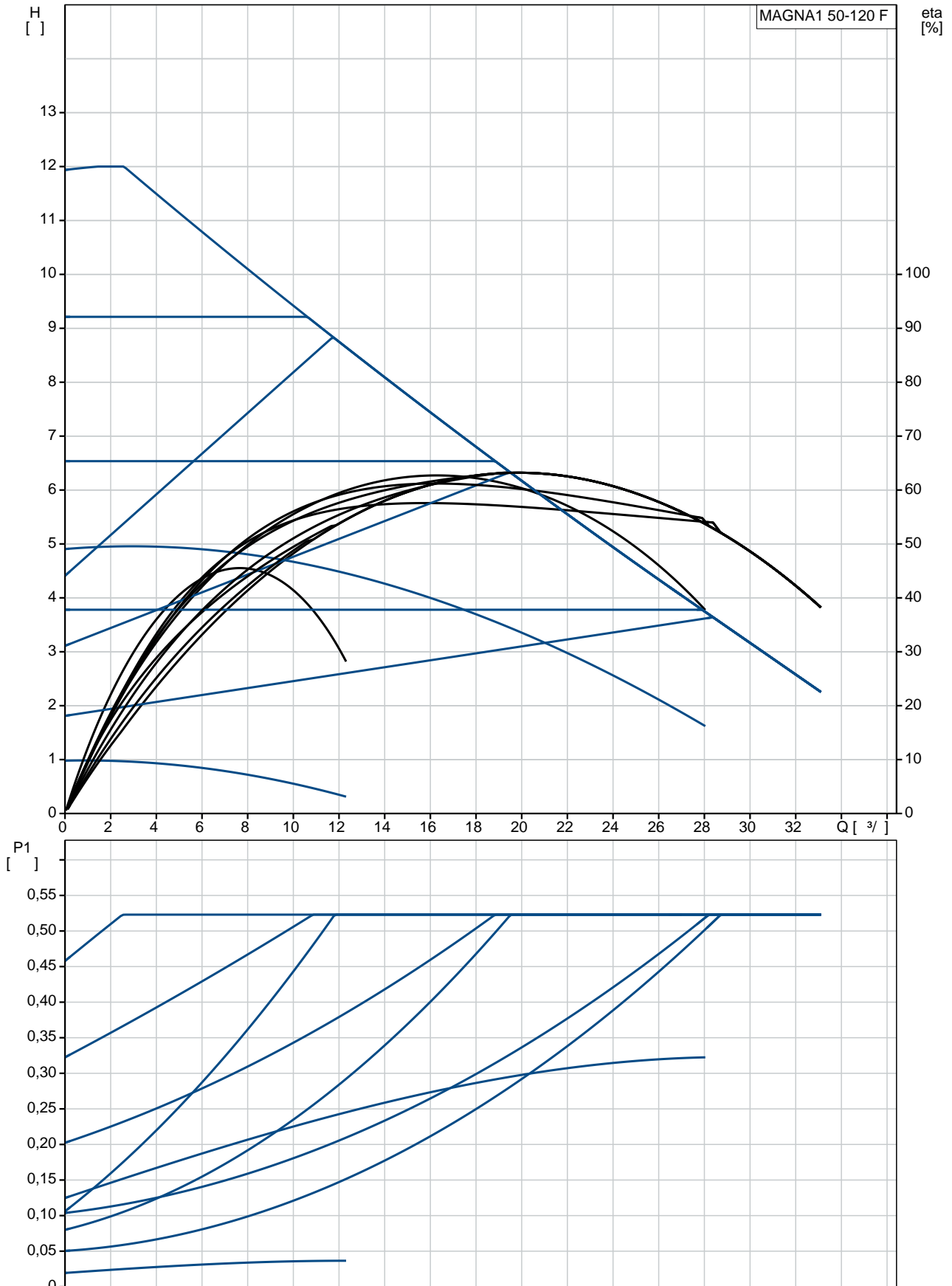

	MAGNA1 50-120 F
	97924192
EAN	5710626492664
	120
TF	110
	CE, VDE, EAC
	B
	EN-GJL-250
	ASTM A48-250B
	PES 30%GF
	0 .. 40 °C
	10
	DIN
	DN 50
	PN6/10
	280
	-10 .. 110 °C
	60 °C
	983.2 / ³
-P1:	20.2 .. 533
	50 Hz
	1 x 230
	0.22 .. 2.37 A
(IEC 34-5):	X4D
(IEC 85):	F
(EEI):	0.21
	17.8
	19.6
	57.4 ³
Danish VVS No.:	380763120
Finnish LVI No.:	4615280
Norwegian NRF no.:	9042847

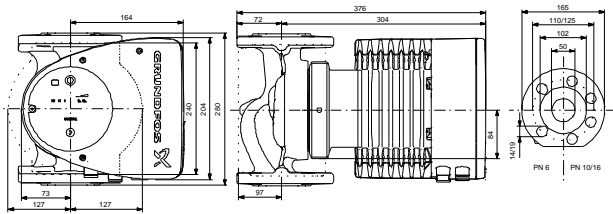
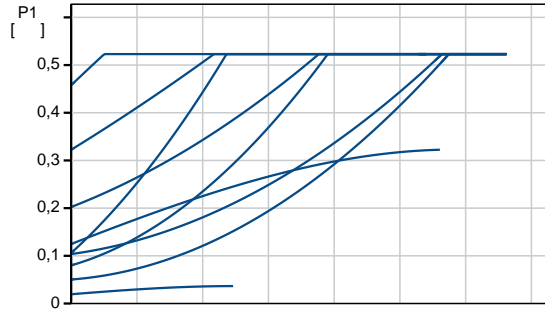
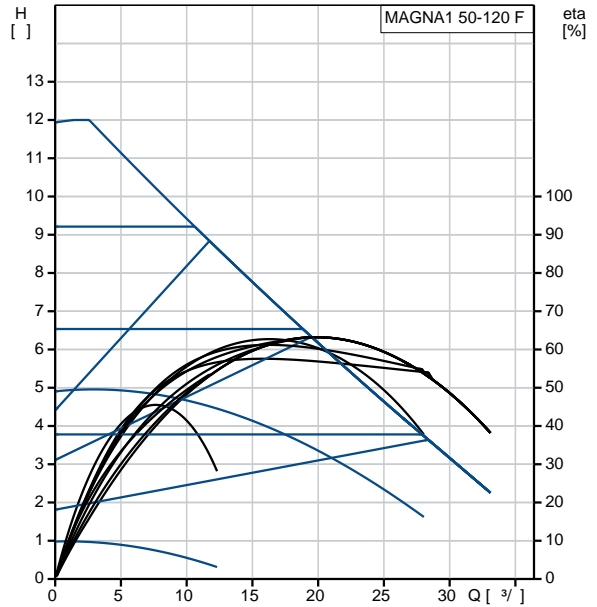

Example of mains-connected motor with mains switch, backup fuse and additional protection

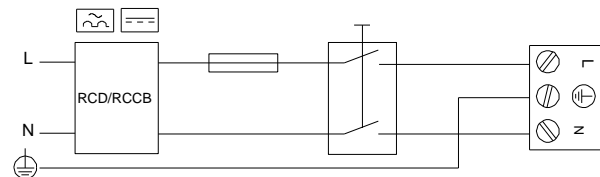

97924192 MAGNA1 50-120 F 50

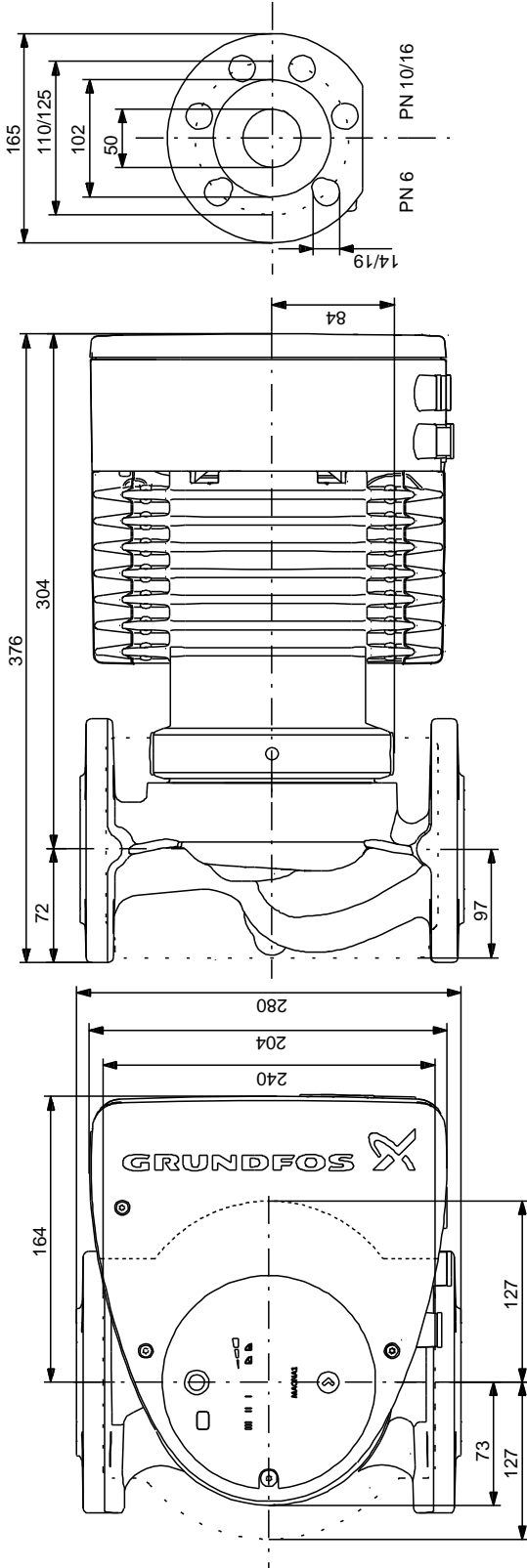

97924192 MAGNA1 50-120 F 50

Example of mains-connected motor with mains switch, backup fuse and additional protection

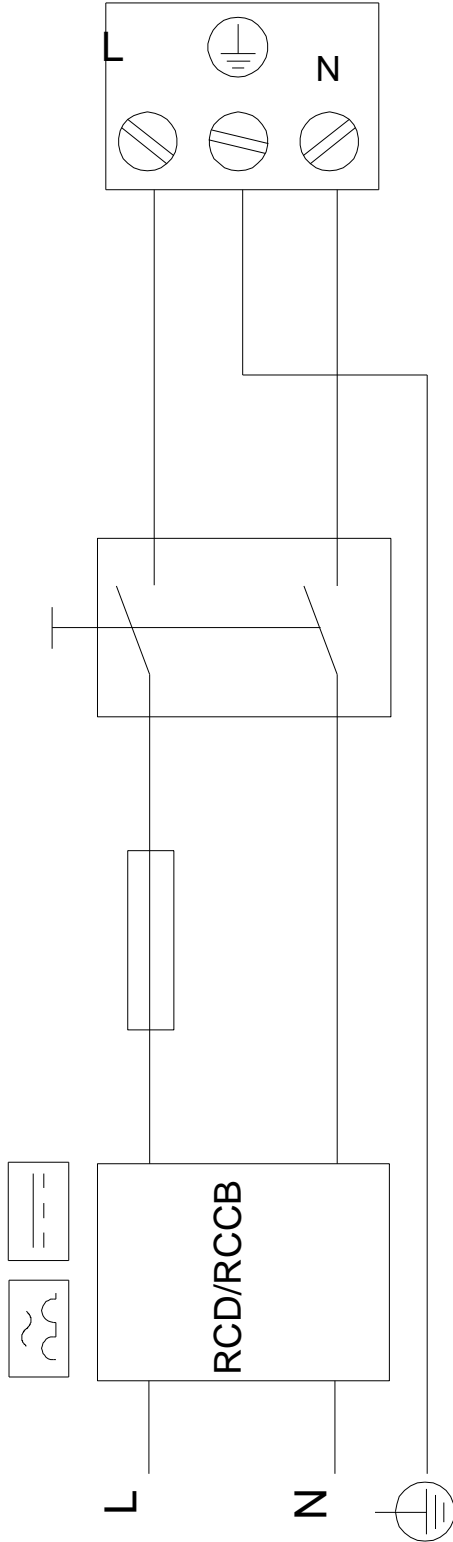

! [], .